



Safety Electrician

---

# Product Manual



Safety Electrician



TNC SWITCH&SOCKET  
FOR OPTIMAL LIGHT



## Z SERIES

TNC Z series switch and socket product has been designed with pure flat front panel, 6mm super thin model, with diamond streamline design, slim and simple.

With elegant and unique matt finish treatment, always the crowd pleaser.



Confident in our workmanship and materials, TNC offer a substantial guarantee on all products.



**25 YEARS**  
quality warranty



Adopted high quality fire resistant PC for faceplate, PA66 Nylon anti-burning base; Big silver alloy contact point, reduce electric arc effectively. Life time of switch is up to 40000 times.

Enhanced safety technique of door protection design in order to avoid mistake plugging. Life time of BS socket is up to 15000 times.



slim: refers to two parts: slim panel and low back, which saved much space for the wiring



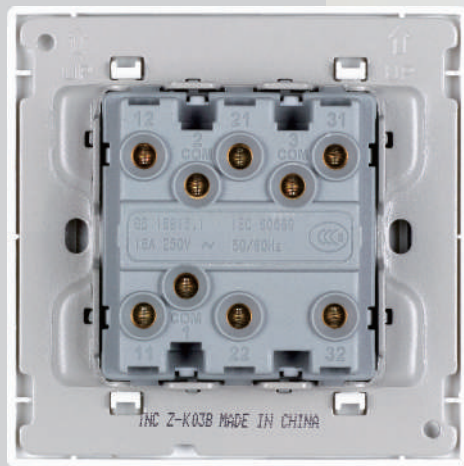

Cone type wiring hole,  
very easy for the wire to insert to the hole

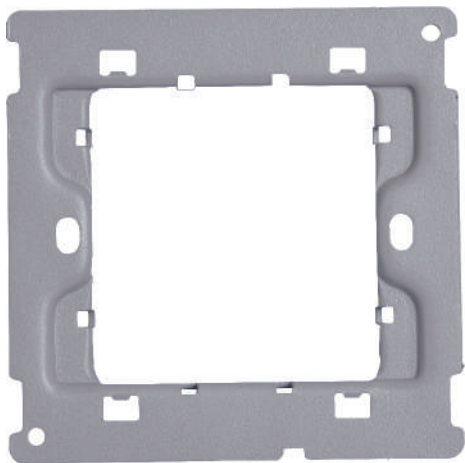

metal plate: 1.2mm metal plate,  
with embossed processing, which  
enhanced the strength of plate,  
without distortion after fixing; The  
surface of metal plate was  
powdered with insulated material,  
pass 3000 voltage insulation test;  
and rust protection, safe and  
reliable



## Panel Material adopts fire-resistant PC

### PC advantages:

1. High strength: anti distortion, anti shock, anti aging.
2. High and low temperature resistant: no deformation/ no cracking between temperature of +120C and -(subzero)40C, fire resistant temperature reaches to 850C, flame on PC dies out within 30S after removed from fire source.
3. No color fading, color well distributed, anti-UV
4. Environmental friendly, no heavy metal, easy to clean.



Insulation pc



Impact  
resistance



**850° C**  
Glow wire test,  
flame dieoff  
within 30 seconds.



Environmental  
friendly

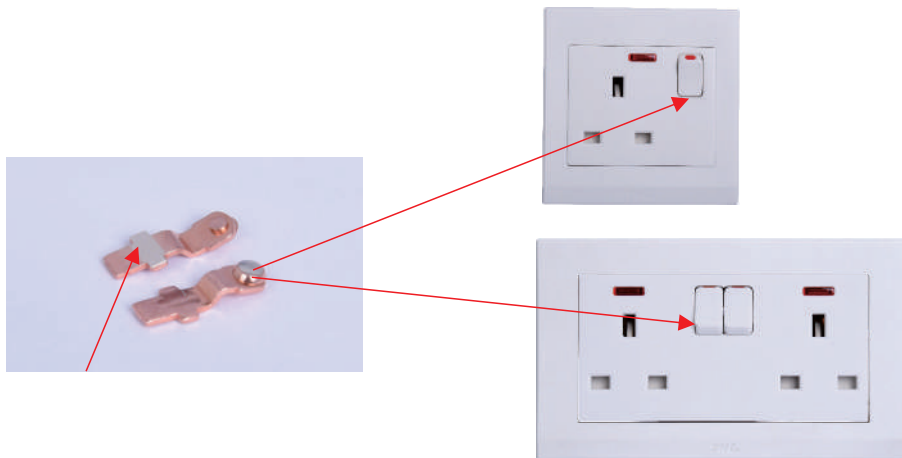

Nickel Silver alloy for the contact point  
Back of contactor is coated with silver,  
better for current running and reduce heat

## Advantages :

1. large contact point.
2. low contact resistant, good conductivity.
3. not easy to have electric arc.
4. high strength.
5. high temperature resistant, low temperature rise ,abrasion resistant, oxidation resistant, long lifespan.

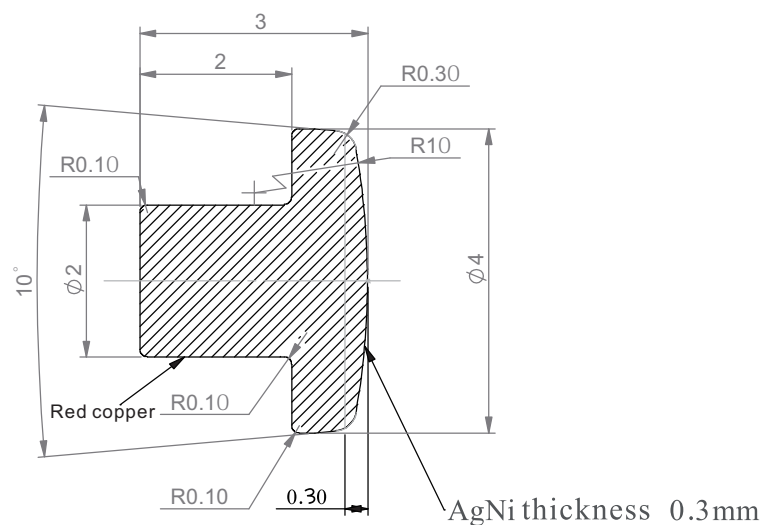

Cross section A-A





Base material adopts VO  
grade fire-resistant PA66 nylon.  
PC plate, by structural strengthening,  
strong enough to install on the wall

Advantages:

1. Stable electrical performance, fire resistant, high temperature .  
resistant, high mechanical strength, durable and not easy to distort.
2. Bending resistant, high impact toughness, high breakdown voltage.
3. No distortion at 125 degrees , fire resistant temperature up to 850C,

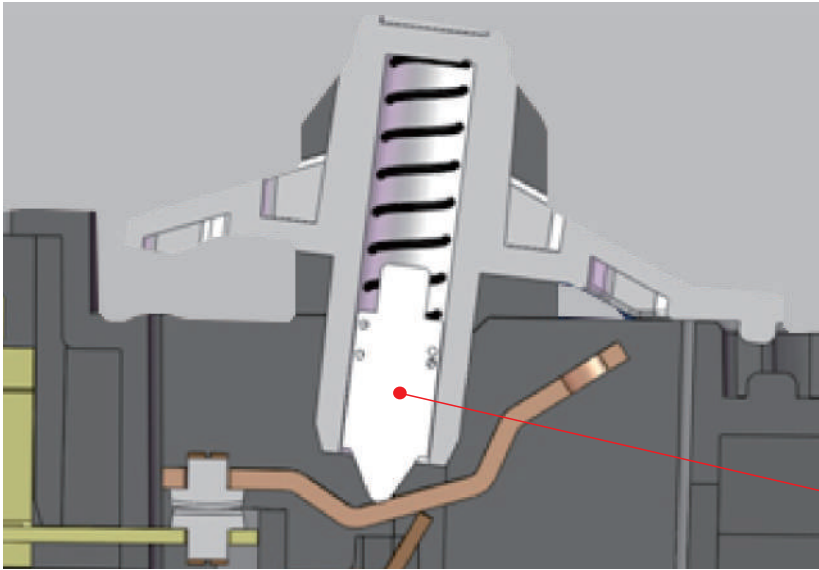

**toggle**

**Toggle:** enhanced translucent DuPont nylon material

**Toggle** in enhanced translucent DuPont nylon material,  
abrasion resistant and high temperature resistant,  
good lubricity and smooth, long lifespan.



**Protection door:**

The materials used are flame retardant PA66 nylon with 15% glass fiber. Abrasion resistant, high temperature resistant, good toughness. Superior protection door design can withstand 20N (Newton) damage test. Protection door locks automatically when plugged in just one hole, to avoid electric shock and ensure safety.

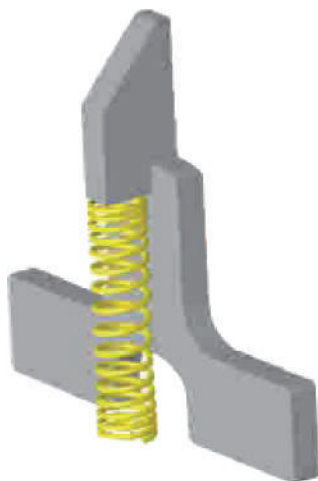

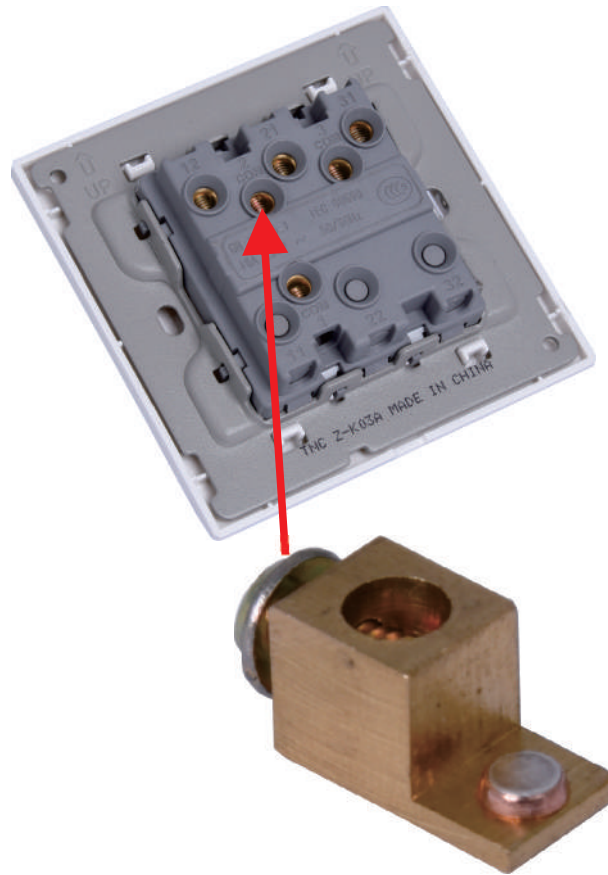

# Terminal

## advantages:

- 1, Brass terminal, better conduction;
- 2, The heat producing is less, and heat radiation is better ;
- 3, The product is heavy with brass terminal, consumers like heavy product;
- 4, The screw cannot come out of the terminal when loosen the wire;

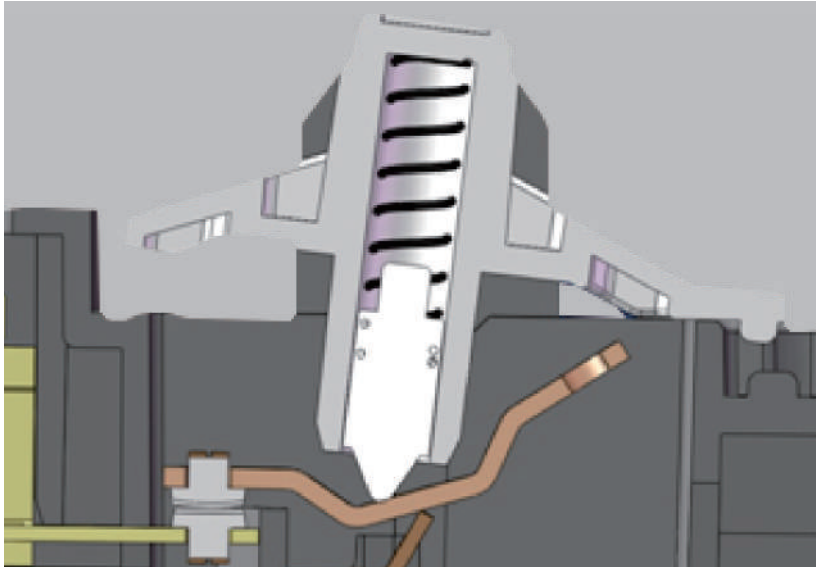

### **Forced breaking function**

TNC switch has Forced breaking function to decrease fire risk. When two contact points adhere with each other due to over current-carrying, push the toggle and they will be forced to disconnect.



## THE PRODUCT STRUCTURE

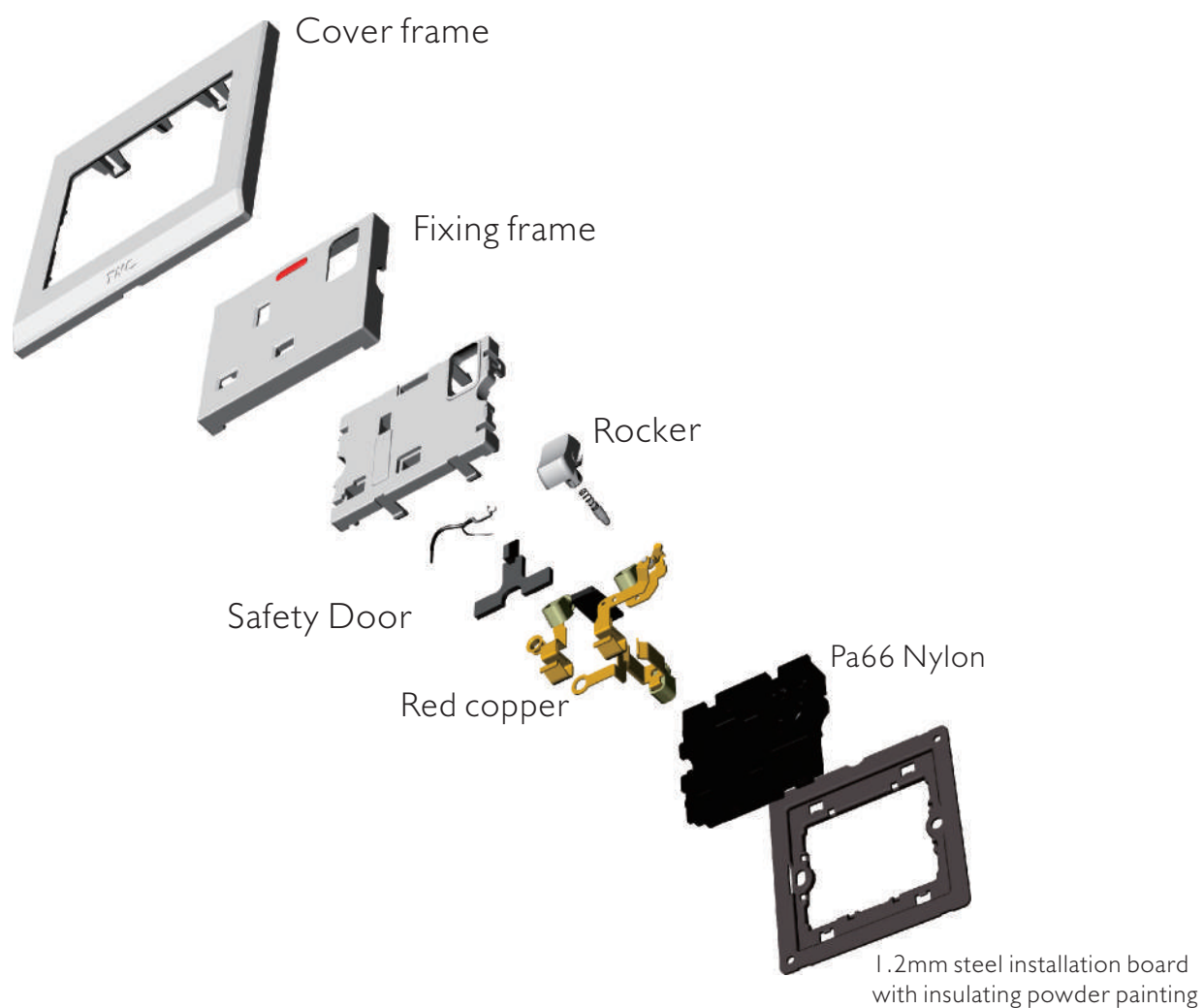



16Amp 10AX switch	14
13Amp Socket Outlets	14
20A DP switch	15
45A DP switch	15
Dimmer switch	16
Information socket	16



## 16Amp 16AX switch

Model NO.	Description	Box	Carton
Z-K01A	1 G 1 W switch	10	100
Z-K01B	1 G 2 W switch	10	100
Z-K02A	2 G 1 W switch	10	100
Z-K02B	2 G 2 W switch	10	100
Z-K03A	3 G 1 W switch	10	100
Z-K04A	4 G 1 W switch	10	100

- All switch 16Amp, 16AX rated
- 86\*86MM size
- Installation opening distance 60.3mm
- Plate-switch manufactured to IEC60669-1
- All switch 250V, AC, 50/60Hz
- Screw terminal
- Minimum mounting box depth: 31.63mm

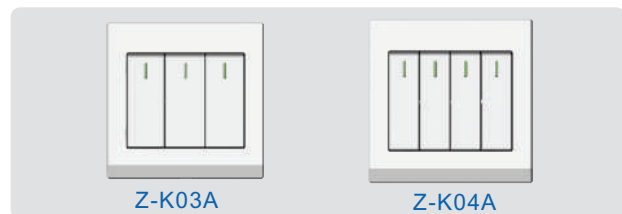
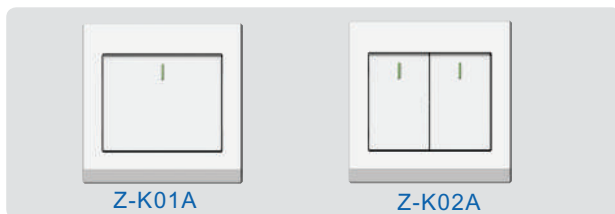

## 13Amp Socket Outlets

Model NO.	Description	Inner Box	Outer Carton
Z-C26-DP	1 G 13A BS socket+switch+ neon	10	100
Z8I3SLD	2 G 13A BS socket+DP switch +neon	10	100
Z8I3-USB	1 gang 13A socket with USB		

- All socket 13Amp rated
- Screw terminal
- Minimum mounting box depth: 27.06mm
- 86\*86MM size
- Installation opening distance 60.3mm
- manufactured to BS1363

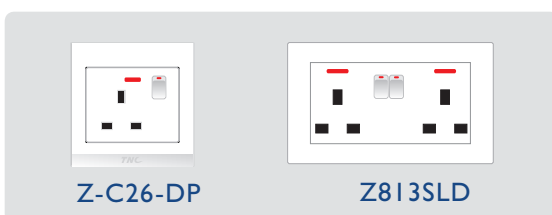

## 20A DP switch

Model NO.	Description	Inner Box	Outer Carton
Z-k28	20A DP switch +neon	10	100

- 86\*86MM size
- Installation opening distance 60.3mm
- Plate-switch manufactured to IEC60669
- 250V~ 50/60Hz
- Screw terminal
- Minimum mounting box depth 21.5MM



Z-K28

## 45A DP switch

Model NO.	Description	Inner Box	Outer Carton
B245L	45A DP switch + neon	10	100

- 86\*86MM size
- Installation opening distance 60.3mm
- Plate-switch manufactured to IEC60669
- Screw terminal
- Minimum mounting box depth 21.5MM



Z245L

## Dimmer switch

Model NO.	Description	Inner Box	Outer Carton
Z-K10	630W dimmer switch	8	80

- 86\*86MM size
- Installation opening distance 60.3mm
- Plate-switch manufactured to IEC60669-2-1
- 220V~ 50/60Hz
- Minimum mounting box depth 26.5MM
- suitable for fluorescent lamps&some kinds of LED



B2-M13

## Information socket

Model NO.	Description	Inner Box	Outer Carton
Z-C09	Satellite TV socket	8	80
Z-C13	TEL socket	8	80
Z-C15	PC socket(cat6)	8	80

- 86\*86MM size
- Installation opening distance 60.3mm
- Plate-switch manufactured to IEC60669
- Screw terminal
- Minimum mounting box depth 21.5MM



Z-C09



Z-C13



Z-C15