

LED BACKLIT PANEL LIGHT

LED BACKLIT FLAT PANEL LIGHT

OPTIMAL LIGHT INTRODUCES NEW BACKLIT LED PANEL LIGHTS.
UNIQUE & EXQUISITE DESIGN
HEAVENLY & HEALTHY LIGHT DISTRIBUTION
LONG LIFE AND EXCEPTIONALLY ECONOMICAL

40 - 45 - 64 - Watt



- CB
- CE
- SASO
- FLICKER FREE
- 50,000 Hrs.
- FIVE YEARS
- 120°
- 115-120 LUMEN/W
- PF >0.9
- UGR <19
- IP 40



SIZES: 600 X 600 600 X 1200 300 X 1200 MM

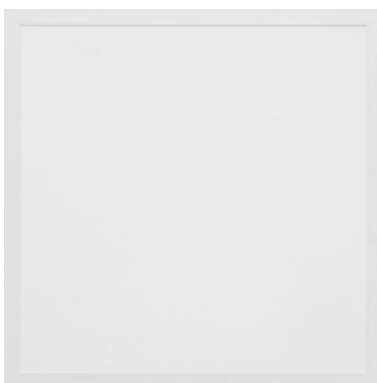

PRODUCT DISPLAY

ECO-FRIENDLY, NO HARMFUL ELEMENTS

ENERGY SAVING UP TO 90% COMPARED TO TRADITIONAL BULBS

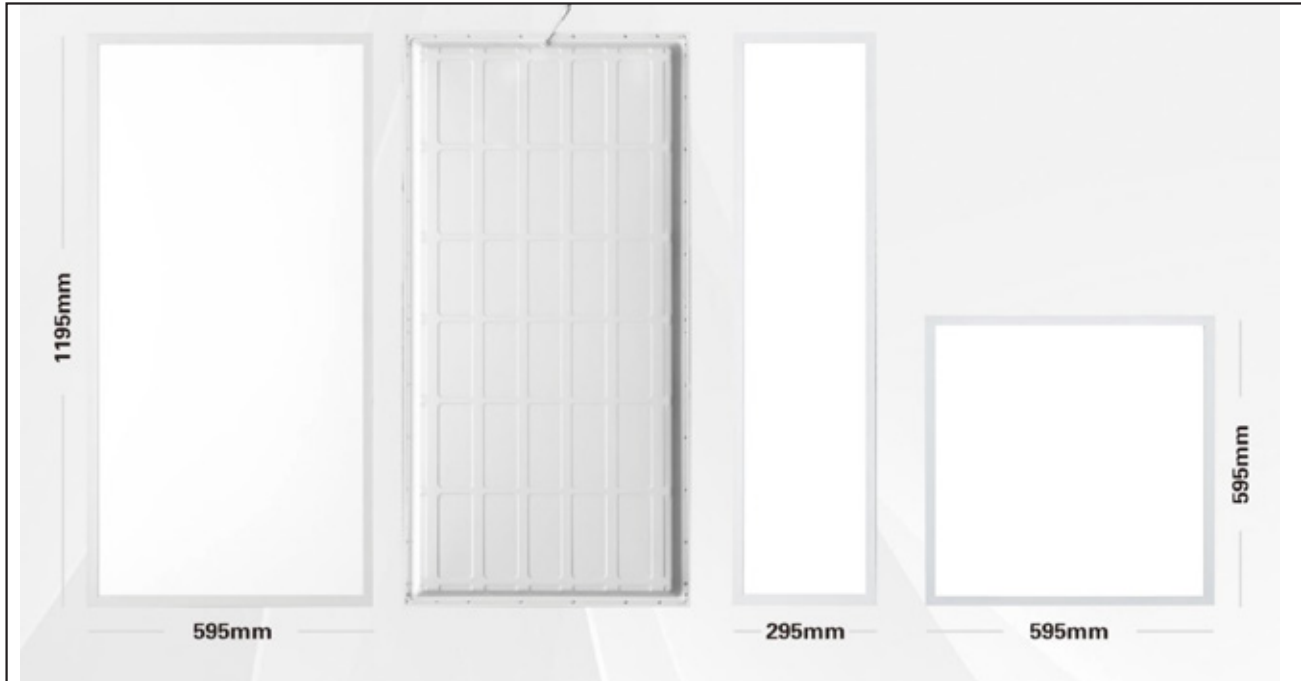

High Quality Led
Pmma Optic Lens

100-277 Volt
50/60 Hz

Housing

LUMINOUS INTENSITY DISTRIBUTION

600 x 600 40W

300 x 1200 45W

600 x 1200 64W

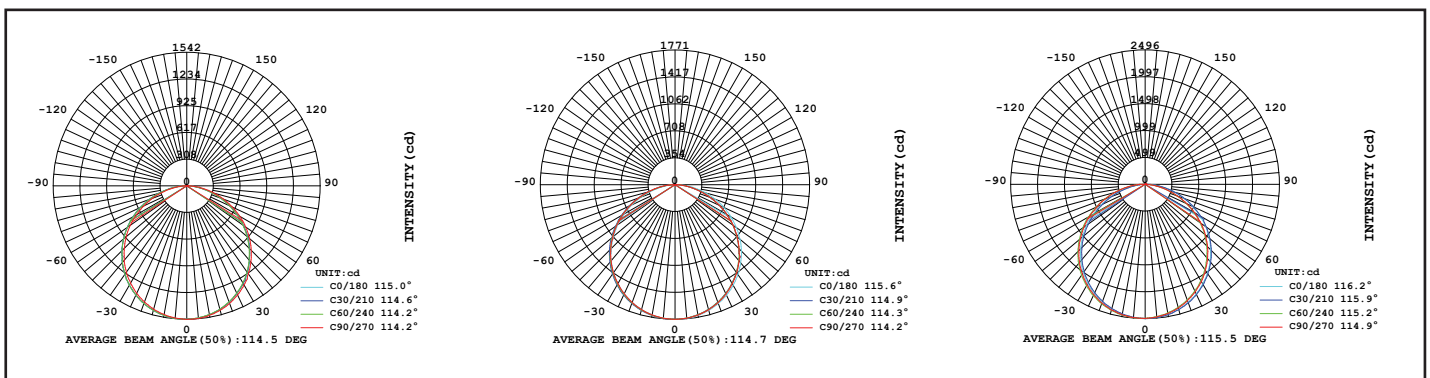

PRODUCT FEATURES:

- Backlit Technology
- Uniform light effect with PMMA optic lens
- Integrated iron plate design provides excellent thermal management
- Consize design offers high cost performance
- Installation: Recessed, Suspended and Surface Mounted
- Driver Input Voltage: 100-277, THD<15 , EMC Surge Protection 3750V
- High brightness with 110-120 lm/ Watt
- Ingress Protection: IP 40 / IP65 (optional)
- Never turn Yellow



TECHNICAL CHARACTERISTICS:

BRAND	OPTIMAL LIGHT	OPTIMAL LIGHT	OPTIMAL LIGHT
MODEL NUMBER	OPT -BL6060-40	OPT -BL3012-45	OPT -BL6012-64
WATTAGE	40 WATT	45 WATT	64 WATT
LUMEN	4400 LM	5000 LM	7400 LM
EFFICIENCY	110 LM/W	110 LM/W	115LM/W
DIMENSIONS	595 X 595 X 30MM	295 X 1195 X 30MM	595 X 1195 X 30MM
LED CHIPS	HIGH QUALITY SMD2835	HIGH QUALITY SMD2835	HIGH QUALITY SMD2835
CCT	3000K / 4000K / 6500K	3000K / 4000K / 6500K	3000K / 4000K / 6500K
CRI	>80	>80	>80
INPUT VOLTAGE	100-277 V AC	100-277 V AC	100-277 V AC
FREQUENCY	50/60 Hz	50/60 Hz	50/60 Hz
BEAM ANGLE	120	120	120
FLICKERING	NO FLICKERING	NO FLICKERING	NO FLICKERING
POWER FACTOR	>0.9	>0.9	>0.9
DISPLACEMENT FACTOR	0.5	0.5	0.5
THD	<15%	<15%	<15%
SURGE PROTECTION	3750V	3750V	3750V
LIFE SWITCHES TIMES	15000	15000	15000
WORKING TEMPERATURE	-20 - +40	-20 - +40	-20 - +40
LIFE TIME	50,000 Hours	50,000 Hours	50,000 Hours
INGRESS PROTECTION	40 / 65 (Optional)	40 / 65 (Optional)	40 / 65 (Optional)
WARRANTY	FIVE YEARS	FIVE YEARS	FIVE YEARS

Mounting Accessories: Surface Mounted Box, Pendant Mounted, Recessed Mounted etc.

Light distribution method:

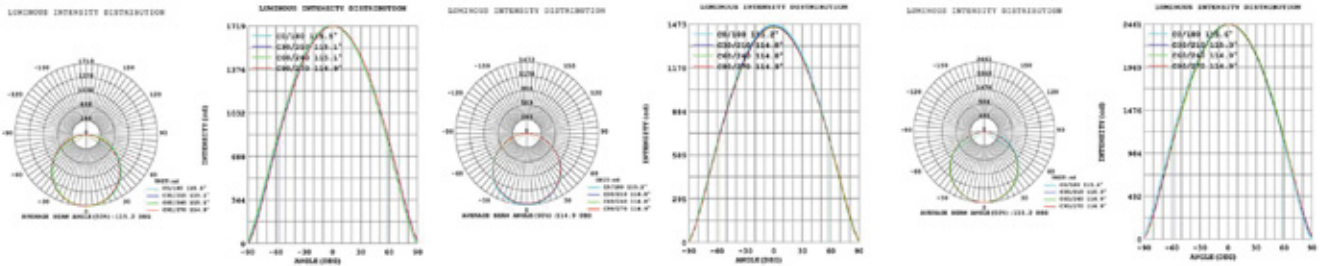

Installation Method :

***Cut off power before installation.

Warning: The lamp is not suitable for mounting on tubular material

Recession

Product size	Cut-out hole
595x595x30mm	575x575mm
295x1195x30mm	275x1175mm
595x1195x30mm	575x1175mm

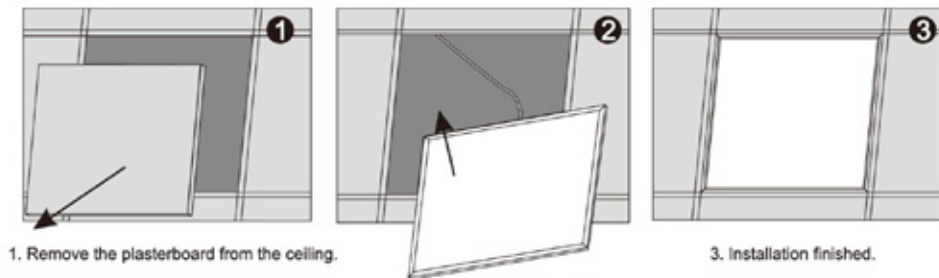

Surfaced mounted

Surfaced Mounted Frame

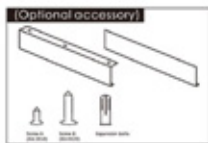

OPT-BL-SMF01

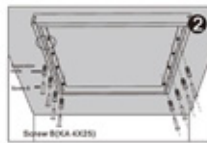

Recessed Frame

OPT-BL-RMF01

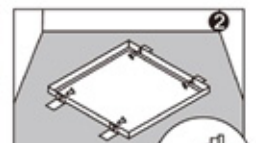
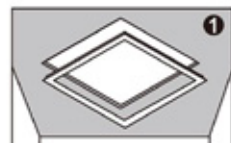

Suspension kit

Suspension kit OPT-BL-SK01

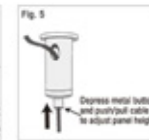
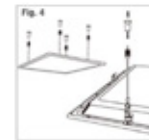
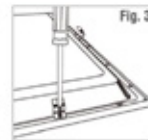
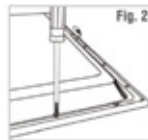
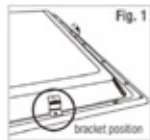

1. Unscrew the screw fixed on the panel light (See Fig. 2), then secured the bracket into the threaded hole using the supplied short screw (See Fig. 3).

2. Use one end of the suspension wire with a metal hook to buckle into the bracket hole, do the same for other 3 suspension wires. (See Fig. 4)

3. Mark and drill the fixing hole in the ceiling, the fixing hole position on the ceiling must same as the 4 suspension wire space have been fixed on the light to keep the light hangs level.

4. Refer to Fig. 5. To adjust the height of the panel, depress the metal button and simply push/pull the wire through the hole in the side of the panel adjustment barrels. Ensure the panel hangs level.

Spring clips

Spring clips

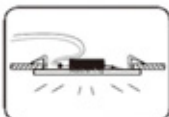
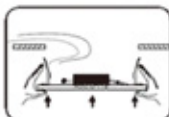
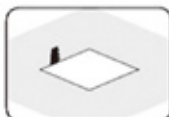

1.remove original screws, enclosed longer screws to assemble springs.

2.open a hole on the ceiling with the size
1.590x560
2.290x1170
3.590x1170

3.one side of springs into the ceiling

4. another side of springs into the ceiling ,Total installation will be finished